

# CNFJ-3000

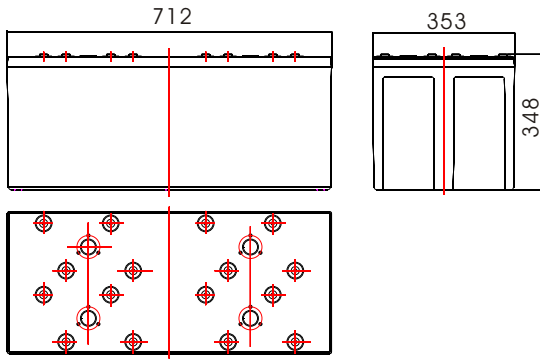

## Specifications

Nominal Voltage		2V
Rated Capacity(10 hour rate)		3000AH
Dimension	Total Height (with terminals)	348mm(13.70inches)
	Height	342mm(13.46inches)
	Length	712mm(28.03inches)
	Width	353mm(13.90inches)
Weight		Approx.192kg(422.91lbs)

## Characteristics

Capacity 77°F(25°C)	120 hour rate (30.0A)	3600AH
	20 hour rate (165A)	3300AH
	10 hour rate (300A)	3000AH
Internal Resistance	Full charged Battery 77°F(25°C)	0.05mΩ
Self - Discharge 77°F(25°C)	Capacity after 3 month storage	95%
	Capacity after 6 month storage	85%
	Capacity after 12 month storage	80%
Max. Discharge Current 77°F(25°C)	30000A(5S)	
Terminal	Standard	F4
	Optional	
Charging (Constant Voltage)	Cycle	Initial Charging Current 900A or small 2.4V~2.48V/77°F(25°C)
	Float	2.25V~2.3V/77°F(25°C)

## Terminal (F4)

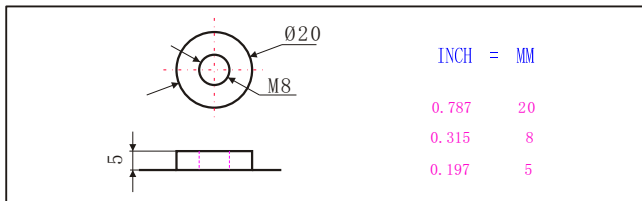

## Charge characteristics 77°F(25°C)

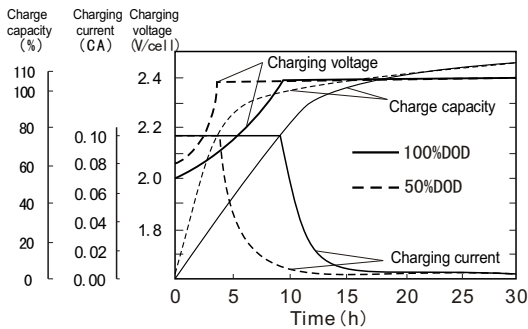

## Discharge characteristics 77°F(25°C)

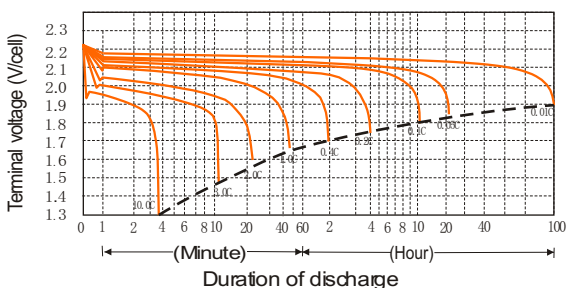

## Discharge current and final discharge voltage

Discharge current (A)	Final discharge voltage (V/cell)
0.05C or below or intermittent discharge	1.9
0.05C of current close to it	1.85
0.1C of current close to it	1.8
0.2C of current close to it	1.75
From 0.2C to 0.5C	1.7
From 0.5C to 1C	1.6
From 1C to 3C	1.5
Current in excess of 3C	1.3

## Temperature and float service life

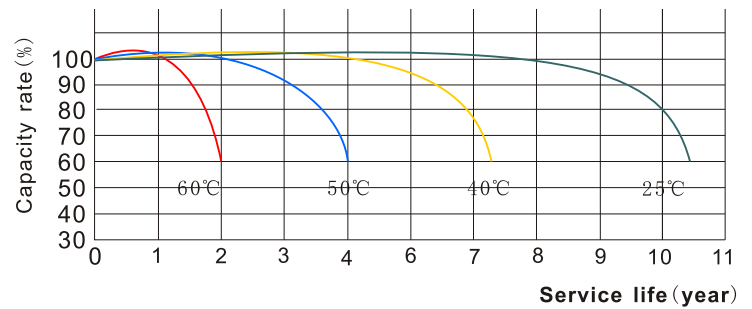

## Temperature and discharge capacity

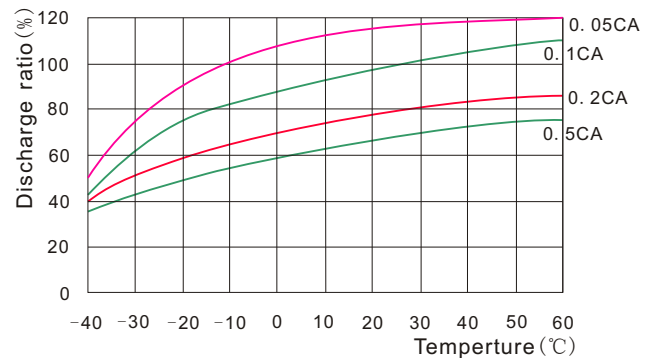

## Cycle life curves (25°C)

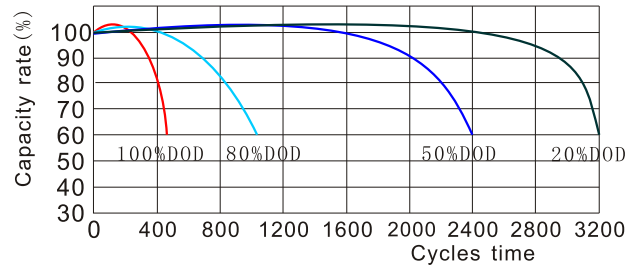

## Float service life

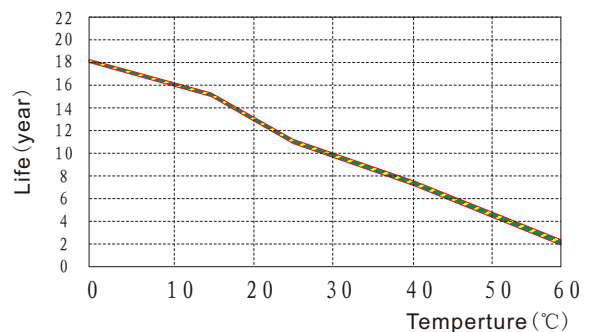

# CNFJ-3000

## Constant Current Discharge Characteristics Units: Amperes (25°C, 77°F)

End voltage per cell	5min	15min	30min	45min	1h	2h	3h	4h	5h	6h	8h	10h	12h	20h	24h
1.60V	8107	5172	3408	2565	2097	1251	909	707	600	516	390	315	266	166	139
1.67V	6978	4689	3159	2430	2031	1194	864	699	570	510	384	309	266	166	139
1.70V	6666	4545	3060	2400	1962	1176	846	693	567	507	381	306	265	166	138
1.75V	6060	4254	2940	2307	1899	1131	822	675	549	495	375	303	263	165	138
1.80V	5358	3897	2829	2223	1818	1092	810	663	537	483	366	300	257	165	137
1.83V	4677	3561	2613	2066	1719	1044	780	636	513	465	354	291	251	164	134
1.85V	3999	3225	2400	1911	1623	999	750	612	492	450	342	283	243	164	130

## Discharge Data with Constant Power Units: Watts per cell (25°C, 77°F)

End voltage per cell	5min	15min	30min	45min	1h	2h	3h	4h	5h	6h	8h	10h	12h	20h	24h
1.60V	13443	9051	6195	4722	3912	2388	1740	1353	1152	1011	765	624	522	324	272
1.67V	12009	8439	5799	4518	3810	2314	1698	1347	1116	999	750	609	522	324	272
1.70V	11622	8220	5640	4470	3702	2253	1629	1338	1095	993	747	603	521	323	271
1.75V	10728	7728	5454	4332	3600	2178	1590	1317	1068	978	732	597	520	322	271
1.80V	9726	7122	5268	4194	3465	2106	1572	1293	1041	963	720	591	507	321	270
1.83V	8589	6594	4920	3930	3291	2028	1518	1251	1005	936	696	576	495	321	264
1.85V	7452	6066	4572	3666	3120	1950	1464	1206	966	909	672	561	483	318	257