

6-CNFT-165

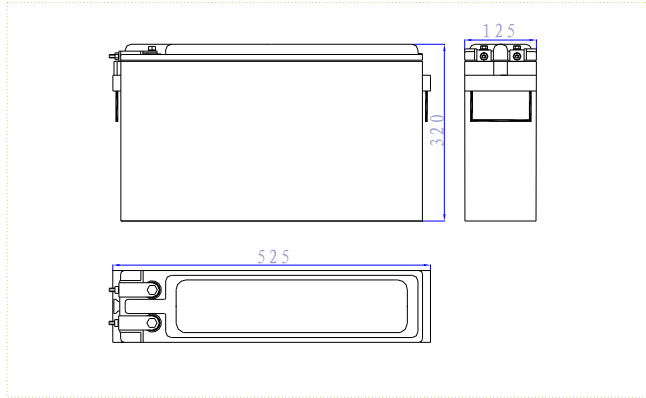

Specifications

Nominal Voltage		12V
Rated Capacity(10 hour rate)		165AH
Dimension	Total Height (with terminals)	320mm(12. 60inches)
	Height	320mm(12. 60inches)
	Length	525mm(20. 67inches)
	Width	125mm(4. 92inches)
Weight		Approx.49. 0kg(107. 93lbs)

Characteristics

Capacity 77°F(25°C)	120 hour rate (1. 65A)	198AH
	20 hour rate (9. 0A)	180AH
	10 hour rate (16. 5A)	165AH
Internal Resistance	Full charged Battery 77°F(25°C)	6. 5mΩ
Self - Discharge 77°F(25°C)	Capacity after 3 month storage	95%
	Capacity after 6 month storage	85%
	Capacity after 12 month storage	80%
Max. Discharge Current 77°F(25°C)	1000A(5S)	
Terminal	Standard	F4
	Optional	
Charging (Constant Voltage)	Cycle	Initial Charging Current 49. 0A or small 14.4V~14.8V/77°F(25°C)
	Float	13.5V~13.8V/77°F(25°C)

Terminal (F4)

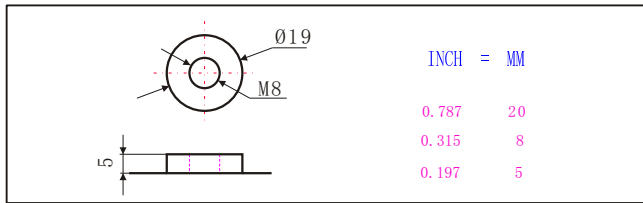

Charge characteristics 77°F(25°C)

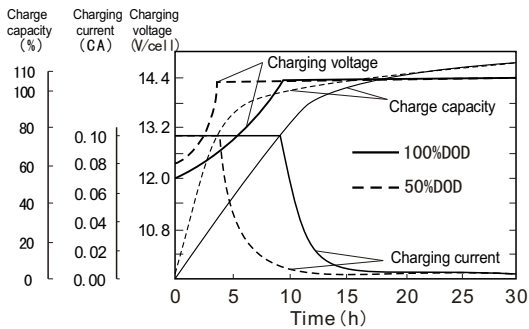

Discharge characteristics 77°F(25°C)

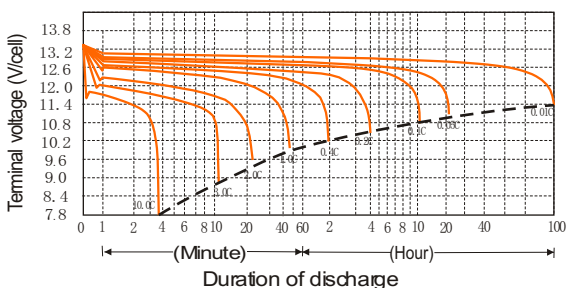

Discharge current and final discharge voltage

Discharge current (A)	Final discharge voltage (V/cell)
0. 05C or below or intermittent discharge	11. 4
0. 05C of current close to it	11. 1
0. 1C of current close to it	10. 8
0. 2C of current close to it	10. 5
From 0. 2C to 0. 5C	10. 2
From 0. 5C to 1C	9. 6
From 1C to 3C	9. 0
Current in excess of 3C	7. 8

Temperature and float service life

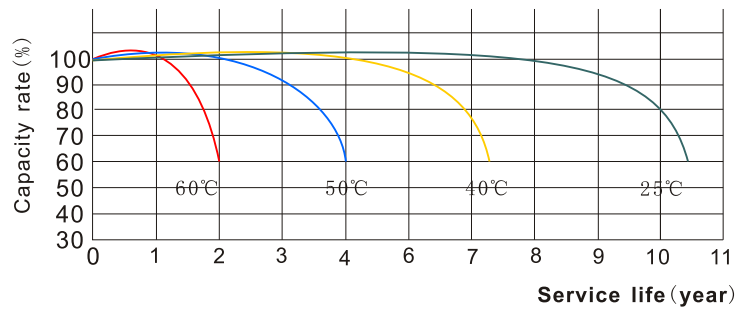

Temperature and discharge capacity

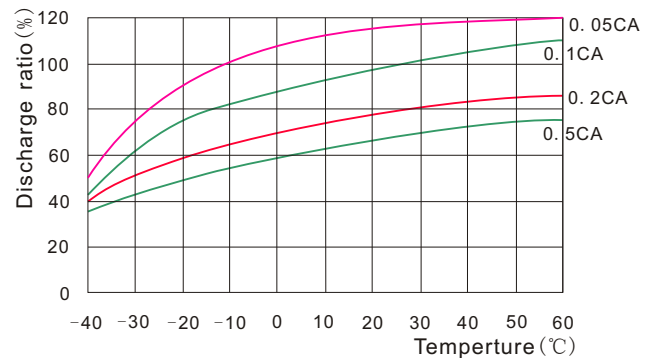

Cycle life curves (25°C)

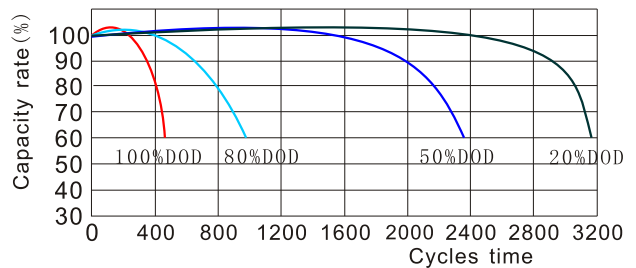

Float service life

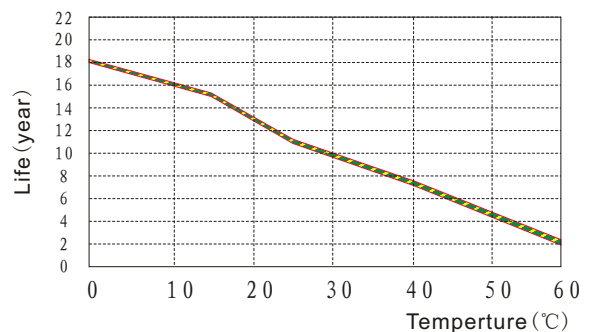

6-CNFT-165

Constant Current Discharge Characteristics Units: Amperes (25°C, 77°F)

End voltage per cell	5min	15min	30min	45min	1h	2h	3h	4h	5h	6h	8h	10h	12h	20h	24h
1.60V	445	284	187	141	115	68.8	49.9	38.8	33.0	28.3	21.4	17.3	14.6	9.12	7.64
1.67V	383	257	173	133	111	65.6	47.5	38.4	31.3	28.0	21.1	16.9	14.6	9.12	7.64
1.70V	366	249	168	132	107	64.6	46.5	38.1	31.1	27.8	20.9	16.8	14.6	9.10	7.62
1.75V	333	233	161	126	104	62.2	45.2	37.1	30.1	27.2	20.6	16.6	14.4	9.10	7.60
1.80V	294	214	155	122	100	60.0	44.5	36.4	29.5	26.5	20.1	16.5	14.1	9.07	7.57
1.83V	257	195	143	113	94.5	57.4	42.9	34.9	28.2	25.5	19.4	16.0	13.7	9.04	7.35
1.85V	219	177	132	105	89.2	54.9	41.2	33.6	27.0	24.7	18.8	15.5	13.3	9.02	7.14

Discharge Data with Constant Power Units: Watts per cell (25°C, 77°F)

End voltage per cell	5min	15min	30min	45min	1h	2h	3h	4h	5h	6h	8h	10h	12h	20h	24h
1.60V	739	497	340	259	215	131	95.7	74.4	63.3	55.6	42.0	34.2	28.7	17.8	14.9
1.67V	660	464	318	248	209	127	93.3	74.0	61.3	54.9	41.2	33.4	28.7	17.8	14.9
1.70V	639	452	310	245	203	123	89.5	73.5	60.2	54.6	41.1	33.1	28.7	17.8	14.9
1.75V	590	425	299	238	198	119	87.4	72.4	58.7	53.7	40.2	32.8	28.7	17.8	14.9
1.80V	534	391	289	230	190	115	86.4	71.1	57.2	52.9	39.6	32.5	27.8	17.6	14.8
1.83V	472	362	270	216	181	111	83.4	68.8	55.2	51.4	38.2	31.6	27.2	17.6	14.5
1.85V	409	333	251	201	171	107	80.5	66.3	53.1	49.9	36.9	30.8	26.5	17.4	14.1