

# 6-CNFT-155

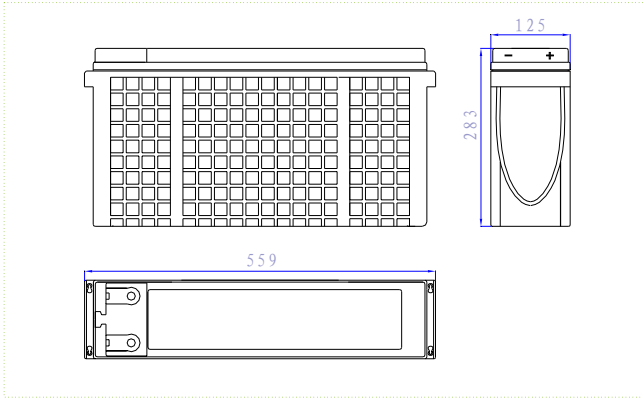

## Specifications

Nominal Voltage		12V
Rated Capacity(10 hour rate)		155AH
Dimension	Total Height (with terminals)	283mm(11.14inches)
	Height	283mm(11.14inches)
	Length	559mm(22.00inches)
	Width	125mm(4.92inches)
Weight		Approx.48.0kg(105.73lbs)

## Characteristics

Capacity 77°F(25°C)	120 hour rate (1.55A)	186AH
	20 hour rate (8.5A)	170AH
	10 hour rate (15.5A)	155AH
Internal Resistance	Full charged Battery 77°F(25°C)	6.5mΩ
Self - Discharge 77°F(25°C)	Capacity after 3 month storage	95%
	Capacity after 6 month storage	85%
	Capacity after 12 month storage	80%
Max. Discharge Current 77°F(25°C)	1000A(5S)	
Terminal	Standard	F4
	Optional	
Charging (Constant Voltage)	Cycle	Initial Charging Current 46.0A or small 14.4V~14.8V/77°F(25°C)
	Float	13.5V~13.8V/77°F(25°C)

## Terminal (F4)

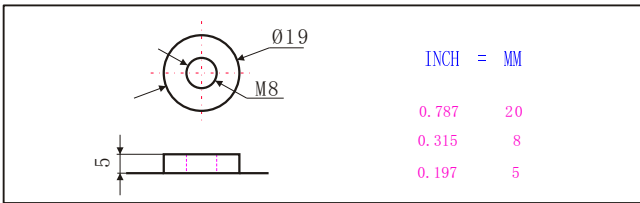

## Charge characteristics 77°F(25°C)

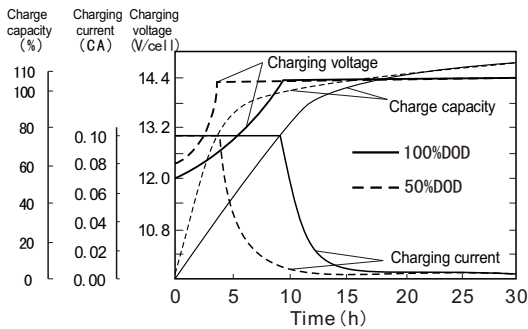

## Discharge characteristics 77°F(25°C)

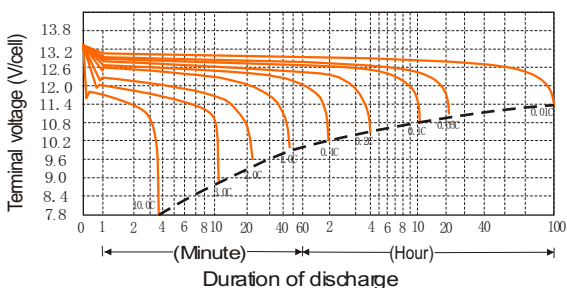

## Discharge current and final discharge voltage

Discharge current (A)	Final discharge voltage (V/cell)
0.05C or below or intermittent discharge	11.4
0.05C of current close to it	11.1
0.1C of current close to it	10.8
0.2C of current close to it	10.5
From 0.2C to 0.5C	10.2
From 0.5C to 1C	9.6
From 1C to 3C	9.0
Current in excess of 3C	7.8

## Temperature and float service life

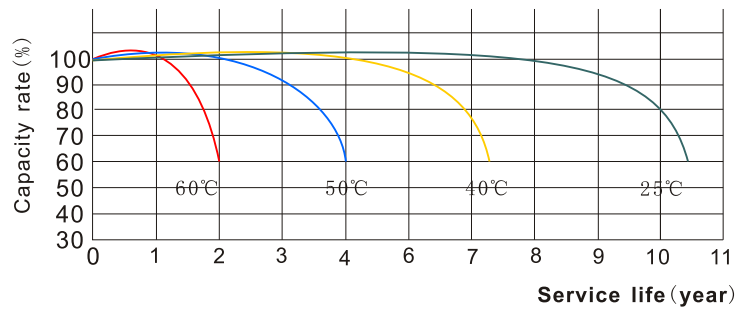

## Temperature and discharge capacity

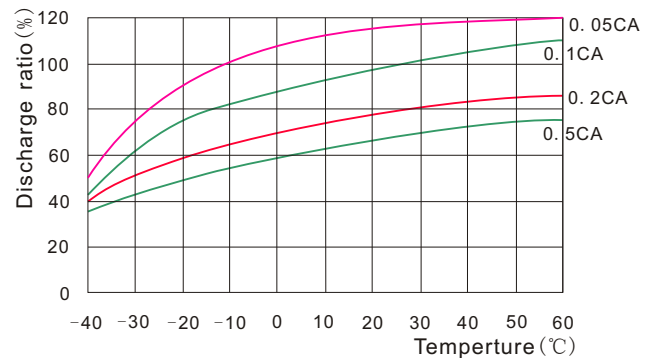

## Cycle life curves (25°C)

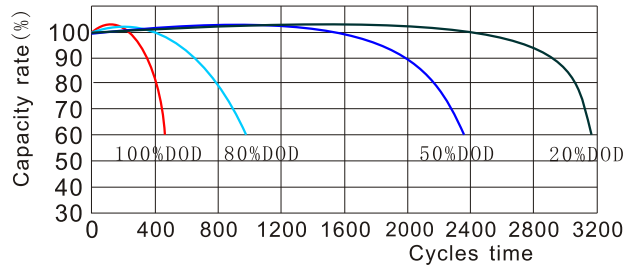

## Float service life

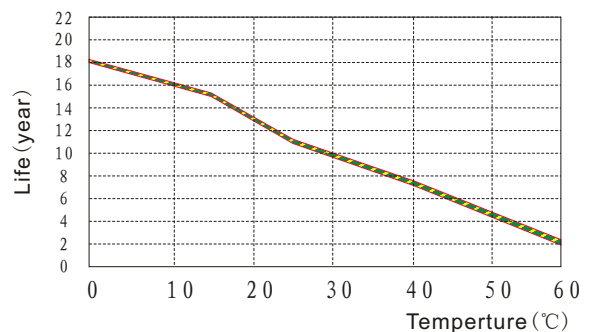

# 6-CNFT-155

## Constant Current Discharge Characteristics Units: Amperes (25°C, 77°F)

End voltage per cell	5min	15min	30min	45min	1h	2h	3h	4h	5h	6h	8h	10h	12h	20h	24h
1.60V	418	267	176	132	108	64.6	46.9	36.5	31.0	26.6	20.1	16.2	13.7	8.57	7.18
1.67V	360	242	163	125	104	61.6	44.6	36.1	29.4	26.3	19.8	15.9	13.7	8.57	7.18
1.70V	344	234	158	124	101	60.7	43.7	35.8	29.2	26.1	19.6	15.8	13.7	8.55	7.16
1.75V	313	219	151	119	98.1	58.4	42.4	34.8	28.3	25.5	19.3	15.6	13.5	8.55	7.14
1.80V	276	201	146	114	93.9	56.4	41.8	34.2	27.7	24.9	18.9	15.5	13.2	8.52	7.11
1.83V	241	183	135	106	88.8	53.9	40.3	32.8	26.5	24.0	18.2	15.0	12.9	8.49	6.91
1.85V	206	166	124	98.7	83.8	51.6	38.7	31.6	25.4	23.2	17.6	14.6	12.5	8.47	6.71

## Discharge Data with Constant Power Units: Watts per cell (25°C, 77°F)

End voltage per cell	5min	15min	30min	45min	1h	2h	3h	4h	5h	6h	8h	10h	12h	20h	24h
1.60V	694	467	320	243	202	123	89.9	69.9	59.5	52.2	39.5	32.2	26.9	16.7	14.0
1.67V	620	436	299	233	196	119	87.7	69.5	57.6	51.6	38.7	31.4	26.9	16.7	14.0
1.70V	600	424	291	230	191	116	84.1	69.1	56.5	51.3	38.6	31.1	26.9	16.7	14.0
1.75V	554	399	281	223	186	112	82.1	68.0	55.1	50.5	37.8	30.8	26.9	16.7	14.0
1.80V	502	367	272	216	179	108	81.2	66.8	53.7	49.7	37.2	30.5	26.1	16.5	13.9
1.83V	443	340	254	203	170	104	78.4	64.6	51.9	48.3	35.9	29.7	25.5	16.5	13.6
1.85V	385	313	236	189	161	100	75.6	62.3	49.9	46.9	34.7	28.9	24.9	16.4	13.2