

# 6-CNFT-100

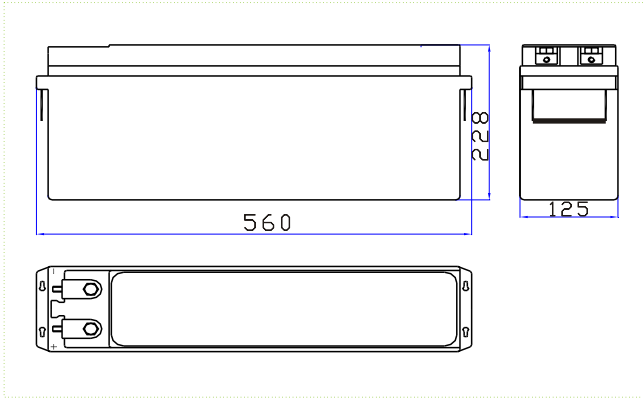

## Specifications

Nominal Voltage		12V
Rated Capacity(10 hour rate)		100AH
Dimension	Total Height (with terminals)	228mm(8.98inches)
	Height	228mm(8.98inches)
	Length	560mm(22.05inches)
	Width	125mm(4.92inches)
Weight		Approx.33kg(72.69lbs)

## Characteristics

Capacity 77°F(25°C)	120 hour rate (1.2A)	120AH
	20 hour rate (5.4A)	108AH
	10 hour rate (10A)	100AH
Internal Resistance	Full charged Battery 77°F(25°C)	6mΩ
	Self - Discharge 77°F(25°C)	
Capacity after 3 month storage		95%
Capacity after 6 month storage		85%
Capacity after 12 month storage		80%
Max. Discharge Current 77°F(25°C)		1000A(5S)
Terminal	Standard	F4
	Optional	
Charging (Constant Voltage)	Cycle	Initial Charging Current 30A or small 14.4V~14.8V/77°F(25°C)
	Float	13.5V~13.8V/77°F(25°C)

## Terminal (F4)

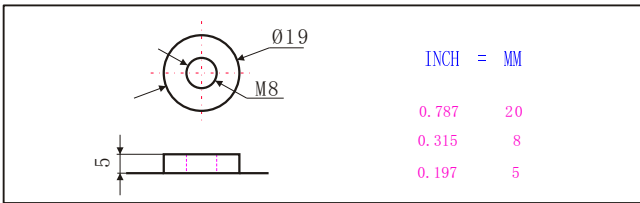

## Charge characteristics 77°F(25°C)

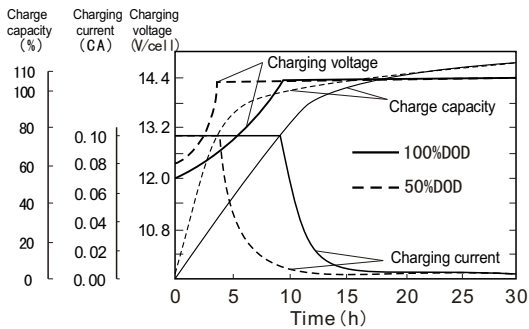

## Discharge characteristics 77°F(25°C)

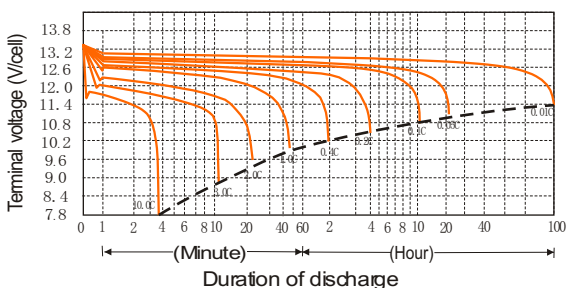

## Discharge current and final discharge voltage

Discharge current (A)	Final discharge voltage (V/cell)
0.05C or below or intermittent discharge	11.4
0.05C of current close to it	11.1
0.1C of current close to it	10.8
0.2C of current close to it	10.5
From 0.2C to 0.5C	10.2
From 0.5C to 1C	9.6
From 1C to 3C	9.0
Current in excess of 3C	7.8

## Temperature and float service life

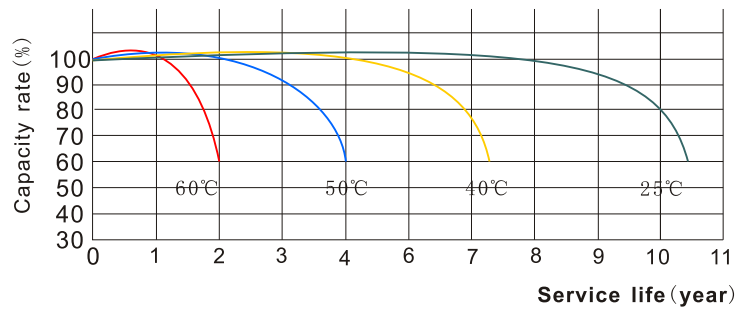

## Temperature and discharge capacity

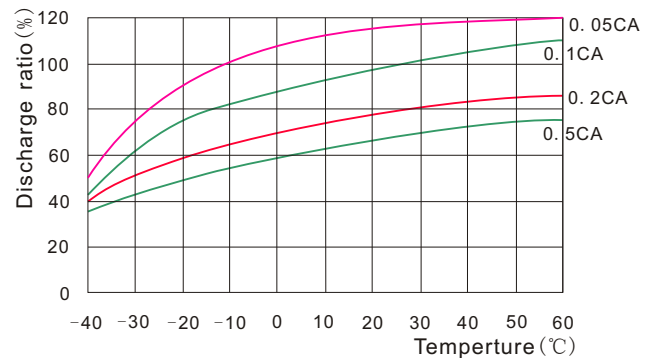

## Cycle life curves (25°C)

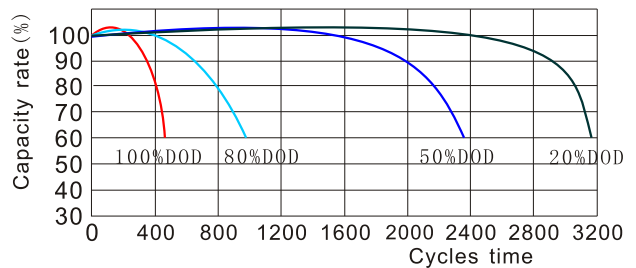

## Float service life

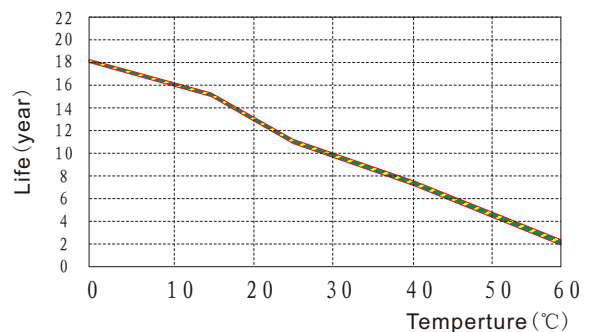

# 6-CNFT-100

## Constant Current Discharge Characteristics Units: Amperes (25°C, 77°F)

End voltage per cell	5min	15min	30min	45min	1h	2h	3h	4h	5h	6h	8h	10h	12h	20h	24h
1.60V	372	200	120	88.8	71.2	40.4	29.1	23.1	19.5	16.8	13.0	10.6	8.92	5.64	4.65
1.67V	345	192	119	88.2	71.0	40.3	28.6	23.0	19.3	16.7	13.0	10.5	8.90	5.62	4.63
1.70V	340	189	117	87.0	70.6	39.9	28.4	22.9	19.1	16.7	13.0	10.5	8.84	5.60	4.63
1.75V	313	185	116	86.4	69.4	39.1	28.3	22.6	18.8	16.5	12.9	10.4	8.81	5.58	4.62
1.80V	284	172	110	84.0	67.6	38.6	28.1	22.5	18.5	16.2	12.9	10.2	8.75	5.37	4.61
1.83V	272	158	108	81.5	64.6	38.1	27.0	21.5	17.9	15.5	12.6	10.0	8.38	5.35	4.55
1.85V	255	152	102	78.9	62.7	36.6	26.3	21.2	17.5	15.1	12.1	9.00	8.26	5.25	4.50

## Discharge Data with Constant Power Units: Watts per cell (25°C, 77°F)

End voltage per cell	5min	15min	30min	45min	1h	2h	3h	4h	5h	6h	8h	10h	12h	20h	24h
1.60V	623	356	220	167	135	76.2	56.2	44.3	37.8	32.5	25.4	20.9	17.6	11.5	9.44
1.67V	602	350	220	166	135	76.2	55.4	44.2	37.7	32.4	25.4	20.9	17.6	11.5	9.44
1.70V	598	348	219	166	134	75.6	55.3	44.1	37.2	32.2	25.2	20.7	17.5	11.4	9.44
1.75V	587	343	219	165	133	75.0	55.2	44.0	37.0	31.8	25.1	20.6	17.5	11.4	9.38
1.80V	520	325	213	161	133	75.0	55.2	43.9	36.8	31.8	25.0	20.5	17.4	11.3	9.38
1.83V	502	298	210	158	127	74.4	53.6	42.3	36.2	30.9	25.0	19.9	17.1	11.3	9.22
1.85V	469	292	196	151	123	73.6	52.0	41.8	35.4	30.3	24.0	19.7	16.8	11.1	9.16