

6-CNFJ-40

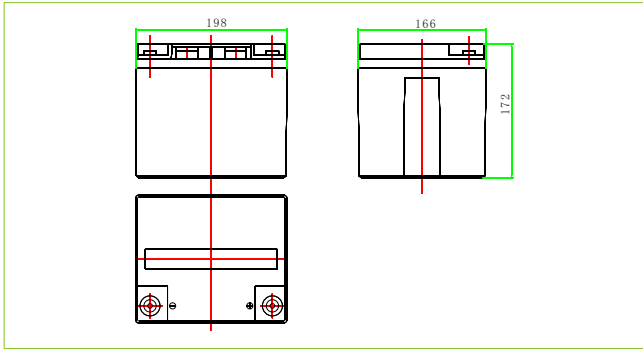

Discharge current and final discharge voltage

Discharge current (A)	Final discharge voltage (V/cell)
0.05C or below or intermittent discharge	11.4
0.05C of current close to it	11.1
0.1C of current close to it	10.8
0.2C of current close to it	10.5
From 0.2C to 0.5C	10.2
From 0.5C to 1C	9.6
From 1C to 3C	9.0
Current in excess of 3C	7.8

Temperature and float service life

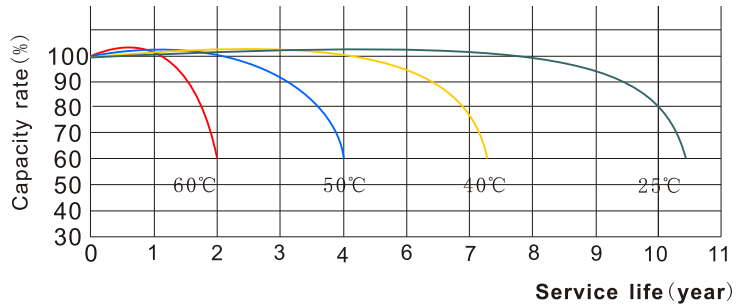

Temperature and discharge capacity

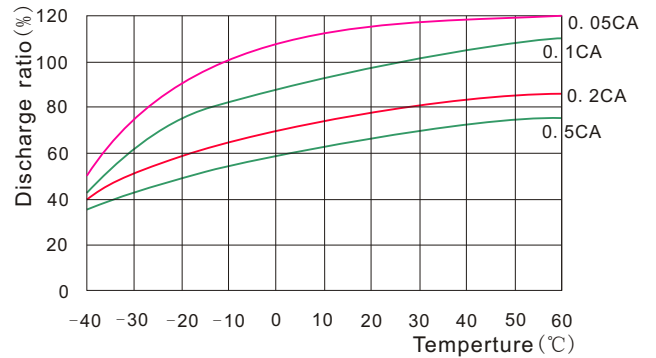

Cycle life curves (25°C)

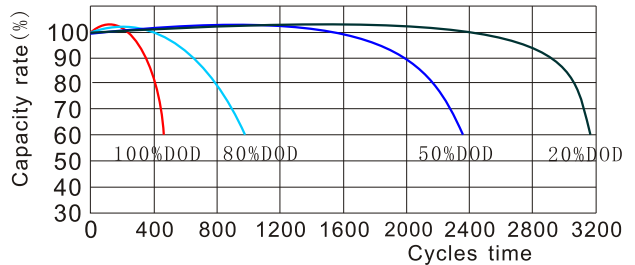

Float service life

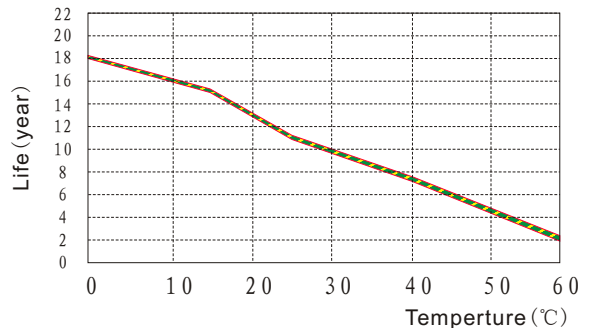

Specifications

Nominal Voltage		12V
Rated Capacity(10 hour rate)		40AH
Dimension	Total Height (with terminals)	172mm(6.77inches)
	Height	172mm(6.77inches)
	Length	198mm(7.8inches)
	Width	166mm(6.54inches)
Weight		Approx.14.5kg(31.94lbs)

Characteristics

Capacity 77°F(25°C)	120 hour rate (0.4A)	48AH
	20 hour rate (2.2A)	44AH
	10 hour rate (4A)	40AH
Internal Resistance	Full charged Battery 77°F(25°C) 8mΩ	
	Self - Discharge 77°F(25°C)	
Capacity after 3 month storage		95%
Capacity after 6 month storage		85%
Capacity after 12 month storage		80%
Max. Discharge Current 77°F(25°C)		400A(5S)
Terminal	Standard	F3
	Optional	
Charging (Constant Voltage)	Cycle	Initial Charging Current 12A or small 14.4V~14.8V/77°F(25°C)
	Float	13.5V~13.8V/77°F(25°C)

Terminal (F3)

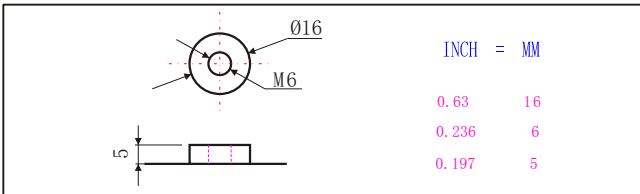

Charge characteristics 77°F(25°C)

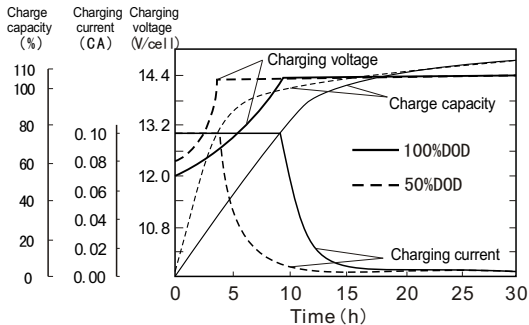

Discharge characteristics 77°F(25°C)

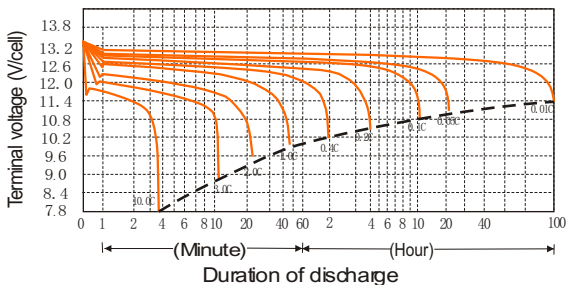

6-CNFJ-40

Constant Current Discharge Characteristics Units: Amperes (25°C, 77°F)

End voltage per cell	5min	15min	30min	45min	1h	2h	3h	4h	5h	6h	8h	10h	12h	20h	24h
1.60V	108	68.9	45.4	34.2	27.9	16.6	12.1	9.42	8.00	6.88	5.20	4.20	3.54	2.21	1.85
1.67V	93.0	62.5	42.1	32.4	27.0	15.9	11.5	9.32	7.60	6.80	5.12	4.12	3.54	2.21	1.85
1.70V	88.8	60.6	40.8	32.0	26.1	15.6	11.2	9.24	7.56	6.76	5.08	4.08	3.54	2.20	1.84
1.75V	80.7	56.7	39.2	30.7	25.3	15.0	10.9	9.00	7.32	6.60	5.00	4.04	3.50	2.20	1.84
1.80V	71.4	51.9	37.7	29.6	24.2	14.5	10.8	8.84	7.16	6.44	4.88	4.00	3.43	2.20	1.83
1.83V	62.3	47.4	34.8	27.5	22.9	13.9	10.4	8.48	6.84	6.20	4.72	3.88	3.34	2.19	1.78
1.85V	53.3	43.0	32.0	25.4	21.6	13.3	10.0	8.16	6.56	6.00	4.56	3.77	3.24	2.18	1.73

Discharge Data with Constant Power Units: Watts per cell (25°C, 77°F)

End voltage per cell	5min	15min	30min	45min	1h	2h	3h	4h	5h	6h	8h	10h	12h	20h	24h
1.60V	179	120	82.6	62.9	52.1	31.8	23.2	18.0	15.3	13.4	10.2	8.31	6.96	4.32	3.62
1.67V	160	112	77.3	60.2	50.8	30.8	22.6	17.9	14.8	13.3	9.99	8.12	6.96	4.32	3.62
1.70V	154	109	75.2	59.6	49.3	30.0	21.7	17.8	14.6	13.2	9.96	8.04	6.96	4.32	3.62
1.75V	143	103	72.7	57.7	48.0	29.0	21.2	17.5	14.2	13.0	9.76	7.95	6.96	4.32	3.61
1.80V	129	94.9	70.2	55.9	46.2	28.0	20.9	17.2	13.8	12.8	9.60	7.88	6.76	4.28	3.60
1.83V	114	87.9	65.5	52.4	43.8	27.0	20.2	16.6	13.4	12.4	9.28	7.68	6.60	4.28	3.51
1.85V	99.3	80.8	60.9	48.8	41.6	26.0	19.5	16.0	12.8	12.1	8.96	7.48	6.44	4.24	3.42